

Montageanleitung

BR 185 - DC
Verdrahtungsschema
Wiring schema

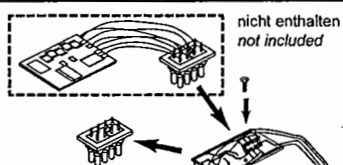

Wir empfehlen / we recommend:
PIKO Standard-Lokdecoder
DCC-Format (Art.-Nr. 56120)
PIKO Multiprotokolldecoder mit
Lastregelung DC/AC (Art.-Nr. 56121)
PIKO standard decoder
DCC format (PIKO art.-no. 56120)
PIKO multi protocol decoder with power
control DC/AC (PIKO art.-no. 56121)

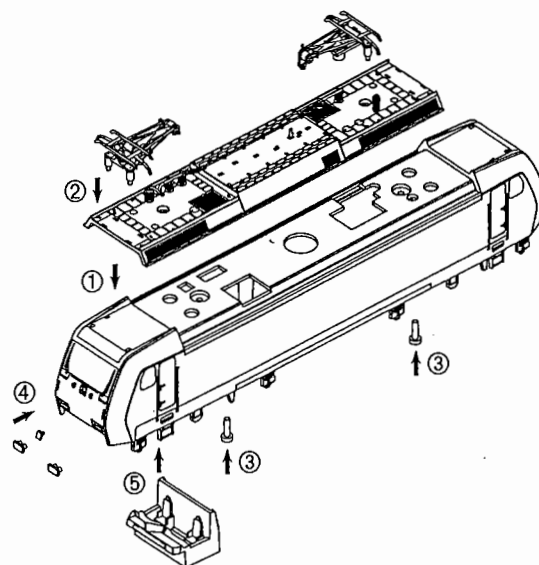
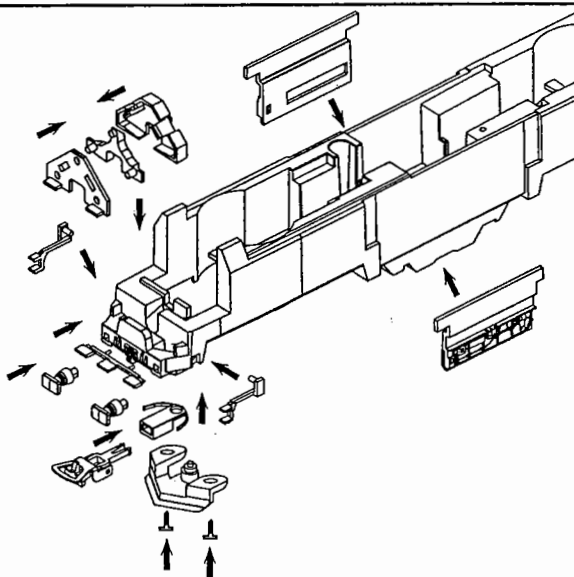
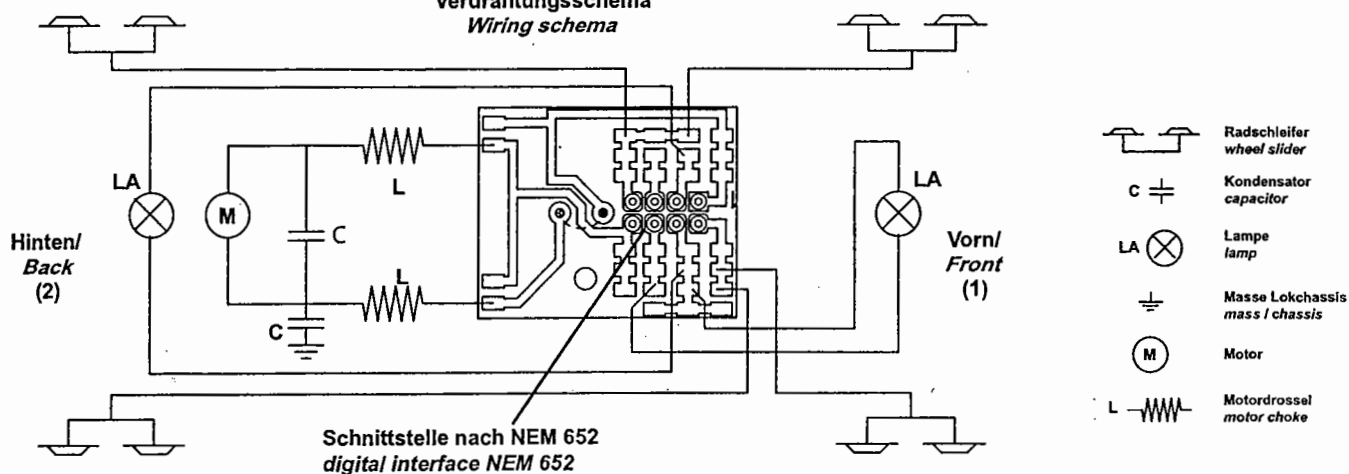